



**HIGHER PLANES** is your source for quality Learjet component Exchanges, Repairs and Overhauls.

## THRUST REVERSER HARDWARE KITS

(AERONCA STYLE)

### LEARJET 35, 36, 55

SCROLL DOWN FOR  
MORE LEARJET  
PARTS AND  
CAPABILITIES

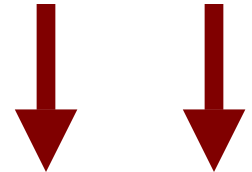

**HP201TR One Engine Hardware Kit**  
**HP200TR Two Engine Hardware Kit**

PART NUMBER	DESCRIPTION	QTY
<b>HP200TR</b>	<b>KIT-TWO ENGINE (1400 HR INSP)</b>	
AN960C10L	WASHER	24
AN960-416	WASHER	4
D6-1	WASHER	90
D6-4	WASHER	8
MS21043-3	NUT	28
MS21043-4	NUT	8
MS24665-151	COTTER PIN	12
MS24665-153	COTTER PIN	10
MS24665-302	COTTER PIN	4
MS9364-10	NUT	8
MS9464-09	PIN	8
NAS1291C4M	NUT	20
NAS1351C3-8	SCREW	20
NAS620C416L	WASHER	8
NAS620-416L	WASHER	32
232-20268-503HP	SHOULDER BOLT	8
232-20426-1HP	BUSHING	8
3515-28-04	WASHER	8
45-12216-1HP	BEARING	8

PART NUMBER	DESCRIPTION	QTY
<b>HP201TR</b>	<b>KIT-ONE ENGINE (1400 HR INSP)</b>	
AN960C10L	WASHER	12
AN960-416	WASHER	2
D6-1	WASHER	45
D6-4	WASHER	4
MS21043-3	NUT	14
MS21043-4	NUT	4
MS24665-151	COTTER PIN	6
MS24665-153	COTTER PIN	5
MS24665-302	COTTER PIN	2
MS9364-10	NUT	4
MS9464-09	PIN	4
NAS1291C4M	NUT	10
NAS1351C3-8	SCREW	10
NAS620C416L	WASHER	4
NAS620-416L	WASHER	16
232-20268-503HP	SHOULDER BOLT	4
232-20426-1HP	BUSHING	4
3515-28-04	WASHER	4
45-12216-1HP	BEARING	4



## PMA THRUST REVERSER PARTS

<u>Part Number</u>	<u>Description</u>
HP201TR	1400 hr Trust Reverser Kit (One Engine)
HP201TR	1400 hr Trust Reverser Kit (Two Engine)
D6-1HP	Washer
D6-4HP	Washer
232-20260-1HP	Bearing
232-20268-503HP	Shoulder Bolt
232-20426-1HP	Bushing
3233190-2HP	Vespel Bearing
45-12216-1HP	Bearing

## PMA DOOR CABLES

<u>Part Number</u>	<u>Description</u>
HP2411660-13	Learjet 24, 24A, 24B, 25B-A, 24C, 24D, 24D-A, 24E, 24F, 24F-A, 25, 25A, 25B, 25C, 25D, 25F, 31, 31A, 35, 35A (C-21A), 36, 36A
HP2411660-15	Learjet 24, 24A, 24B, 25B-A, 24C, 24D, 24D-A, 24E, 24F, 24F-A, 25, 25A, 25B, 25C, 25D, 25F, 31, 31A, 35, 35A (C-21A), 36, 36A
HP2411660-18	Learjet 24, 24A, 24B, 25B-A, 24C, 24D, 24D-A, 24E, 24F, 24F-A, 25, 25A, 25B, 25C, 25D, 25F, 31, 31A, 35A (C-21A), 36, 36A
HP2411660-34	Learjet 24, 24A, 24B, 25B-A, 24C, 24D, 24D-A, 24E, 24F, 24F-A, 25, 25A, 25B, 25C, 25D, 25F, 31, 31A, 35, 35A (C-21A), 36, 36A
5415530-5HP	Learjet 55, 55B, 55C, 60
5415542-16HP	Learjet 55
5415542-23HP	Learjet 55, 55B, 55C
5415542-26HP	Learjet 55, 55B, 55C
6015550-002HP	Learjet 60
6015550-003HP	Learjet 60



## 3231254-1 & 3231254-2 THRUST REVERSER AIR MOTOR GEAR REPAIR

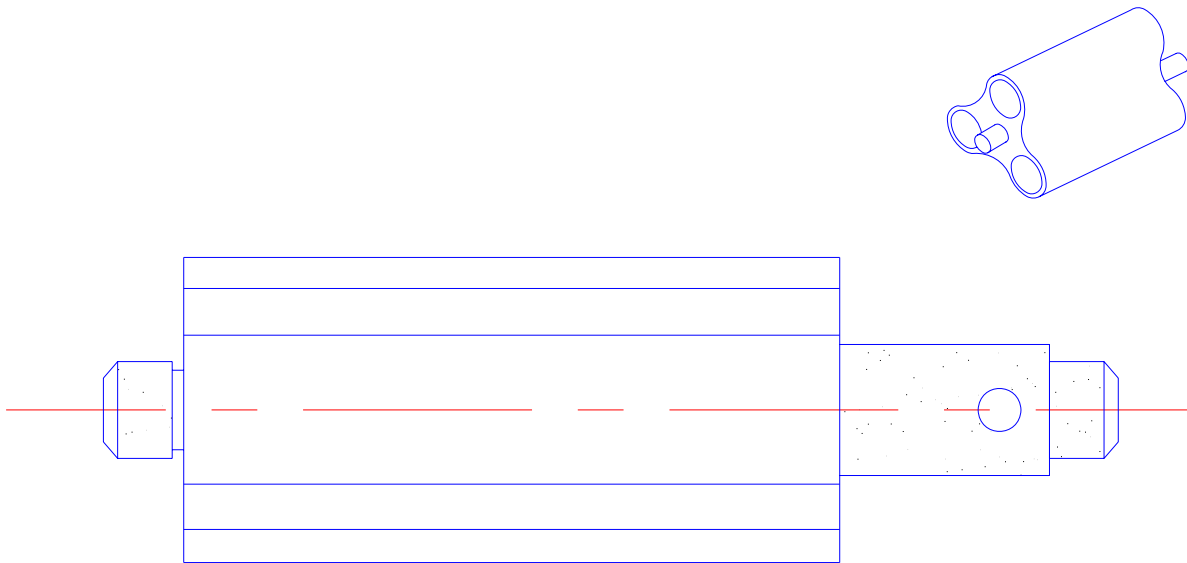

### Options

### Repair

*INSPECTION FEES APPLY*



## 39-14910 DUAL PRESSURE VALVE BODY REPAIR

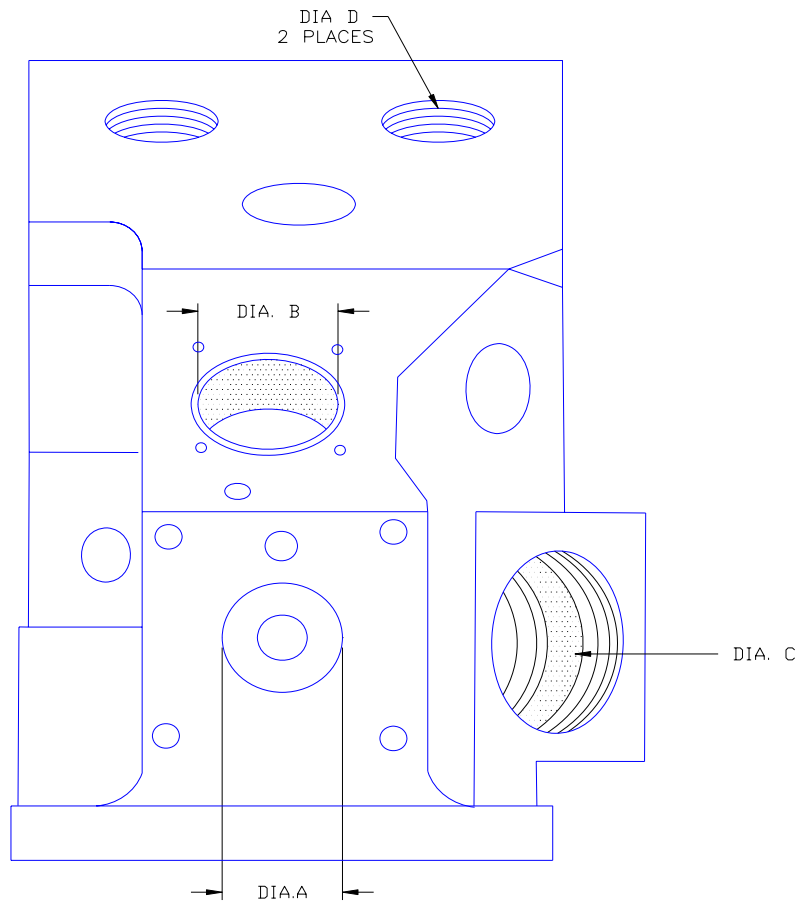

### Options

- Repair Diameter A
- Repair Diameter B
- Repair Diameter C
- Repair Diameter D - Right Bore
- Repair Diameter D - Left Bore

***INSPECTION FEES APPLY***



## **ADDITIONAL LEARJET REPAIRS**

<b><u>Part Number</u></b>	<b><u>Description</u></b>	<b><u>Repair</u></b>
234-2102-1	Nose Gear Housing	Repair Main Bore
2441011 Series	Cylinder	Repair Main Bore Repair Diameter D
2317108-8	Cylinder End	Repair Bore
232-20242-5	Latch Housing	Repair
232-20242-7	Latch Housing	Repair

***INSPECTION FEES APPLY***

**CALL FOR A COMPLETE LIST OF  
LEARJET CAPABILITIES  
PH: (936) 494-1717  
TOLL FREE: (877) 309-4100**